

S1, S2 CONNECTORS

TERMINAL BLOCK PLUGS

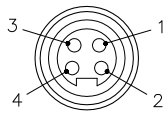

1 = - VOLTAGE
2 = + VOLTAGE
3 = SHIELD
4 = GROUND

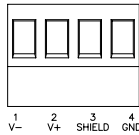

1 = - VOLTAGE
2 = + VOLTAGE
3 = SHIELD
4 = GROUND



FOUNDATION™
fieldbus

FOUNDATION™
fieldbus

SPECIFICATIONS

HOUSING MATERIAL	NYLON 66 - 33% GLASS FILLED/BLACK
RECEPTACLE HOUSING MATERIAL/FINISH	STAINLESS STEEL/PASSIVATED
CONTACT CARRIERS/COLOR	TPU/BLACK
CONTACT MATERIAL/PLATING	BRASS/GOLD
OPERATING VOLTAGE	12-32 V
VOLTAGE SURGE PROTECTION	>36 VDC
OPERATING CURRENT	< 10 mA
OUTPUT CURRENT LIMIT	63 mA
OPTIONAL TERMINATOR RESISTOR	1 OF 2 SWITCHES IN "ON" POSITION
PROTECTION CLASS to DIN 40050	IP 67 - ONLY WHEN ALL RECEPTACLES ARE COVERED WITH PLUGS OR CONNECTED
OPERATING TEMPERATURE	-30°C to +80°C (-22°F to +176°F)

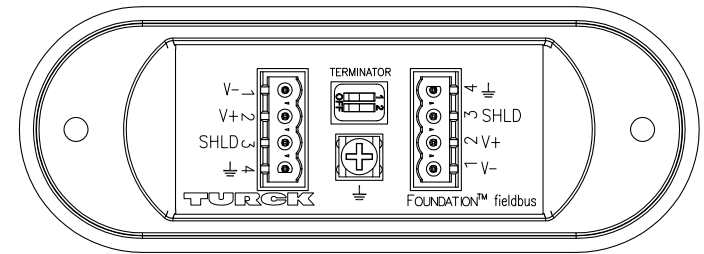
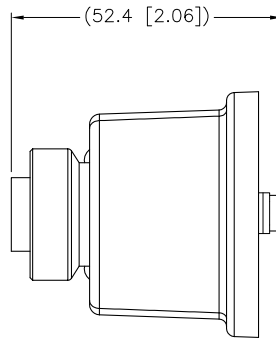
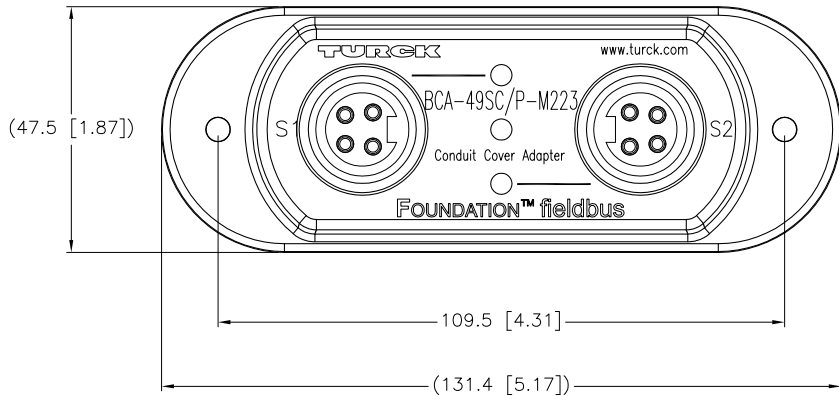

NOTES:

1. "/P" INDICATES SPECIAL GASKET FOR PVC-COATED, CONDUIT BODIES. INCLUDES NYLON COVER SCREWS.

NYLON COVER SCREWS INCLUDED

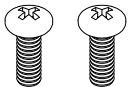

FORM 8 CONDUIT BODIES:
10-24 SCREWS

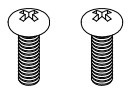

MARK 9 CONDUIT BODIES:
8-32 SCREWS

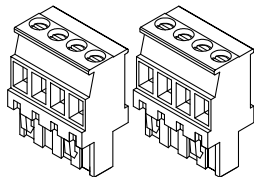

TERMINAL PLUGS INCLUDED

SOURCE DRAWING - FOR REFERENCE ONLY

RELATED DOCUMENTS 1. 2. 3. 4.	3RD ANGLE PROJECTION 	THIS DRAWING IS PROPERTY OF TURCK INC. USE OF THIS DOCUMENT WITHOUT WRITTEN PERMISSION IS PROHIBITED.		3000 CAMPUS DRIVE MINNEAPOLIS, MN 55441 1-800-544-7769 (763) 553-7300 (763) 553-0708 fax turck.com	
	MATERIAL	DRFT RDS	DATE 01/15/07	DESCRIPTION BCA-49SC/P-M223	
FINISH	ALL DIMENSIONS DISPLAYED ON THIS DRAWING ARE FOR REFERENCE ONLY	DSGN	SCALE 1=1.5	IDENTIFICATION NO. U3-01263	
	CONTACT TURCK FOR MORE INFORMATION	UNIT OF MEASUREMENT MILLIMETER [INCH]		REV C	
		DO NOT SCALE THIS DRAWING		FILE: U3-01263	SHEET 1 OF 1

C	DRAWING PROCESSED AS PART OF ECO 33971	CBM	04/07/11	33971
REV	DESCRIPTION	BY	DATE	ECO NO.